

A/25066/405/197

Planning Permit No. _____
APPROVED
 SUBJECT TO THE CONDITIONS IN THIS OFFICE LETTER.
 No. A/2/16/29/197 - 937
 FOR MEMBER SECRETARY
 MADRAS METROPOLITAN
 DEVELOPMENT AUTHORITY
 MADRAS - 600 008.

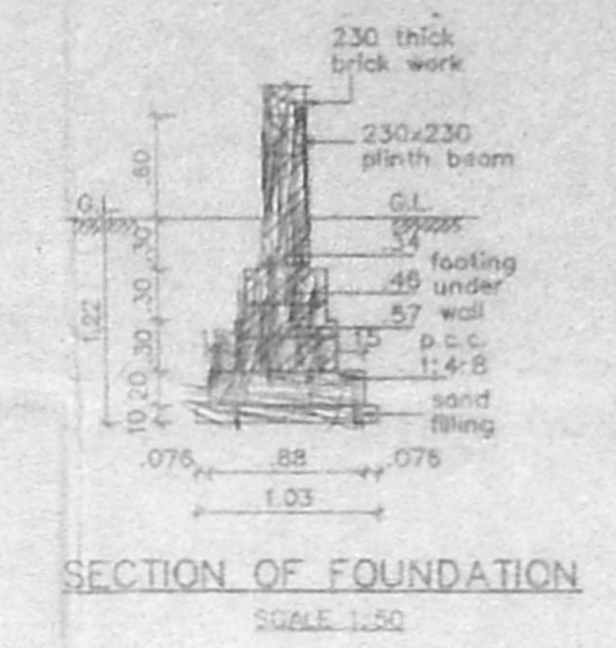
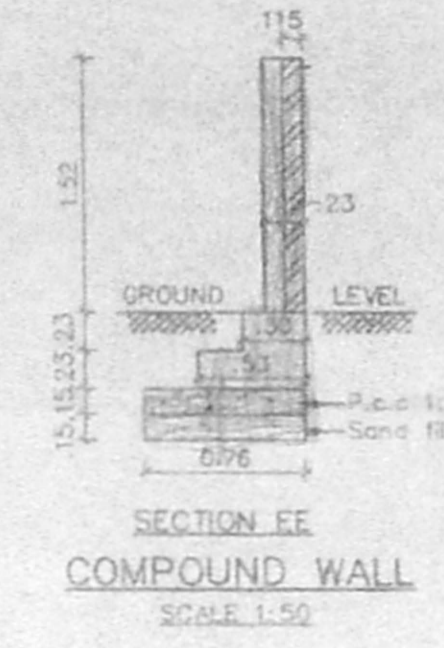
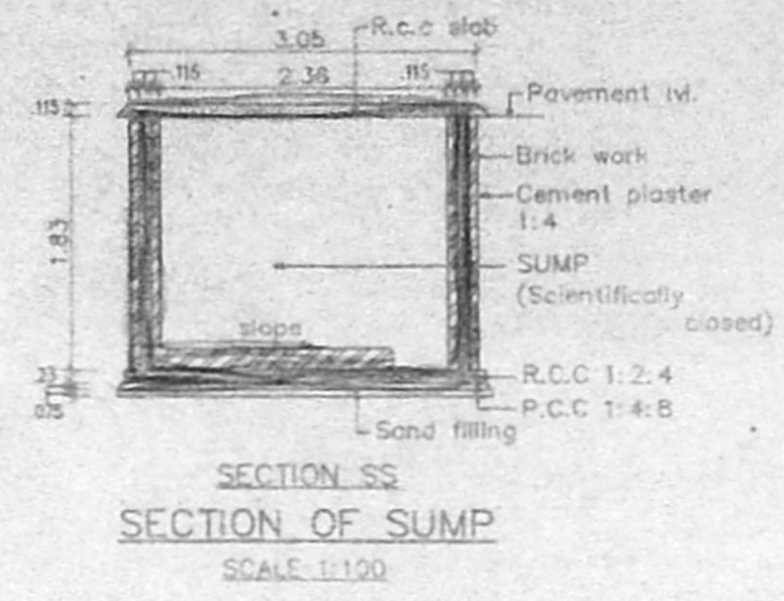
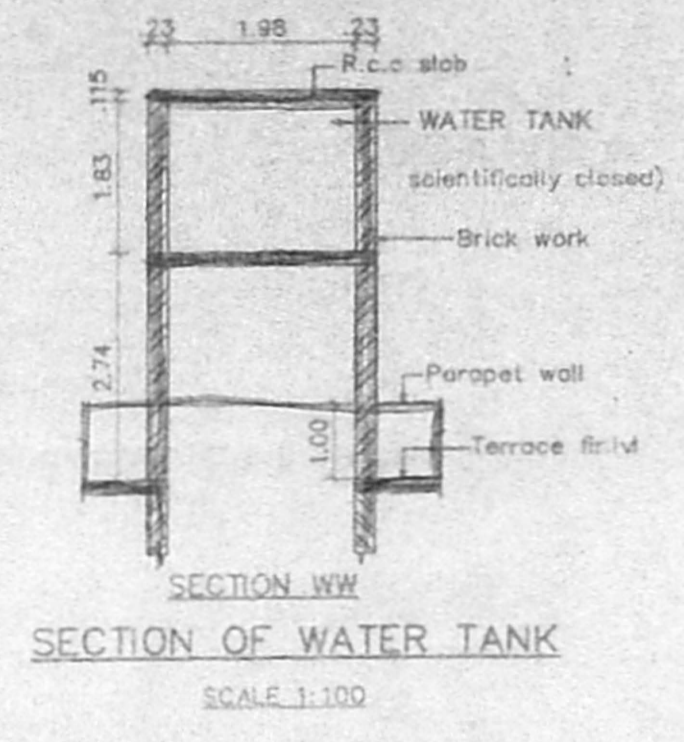
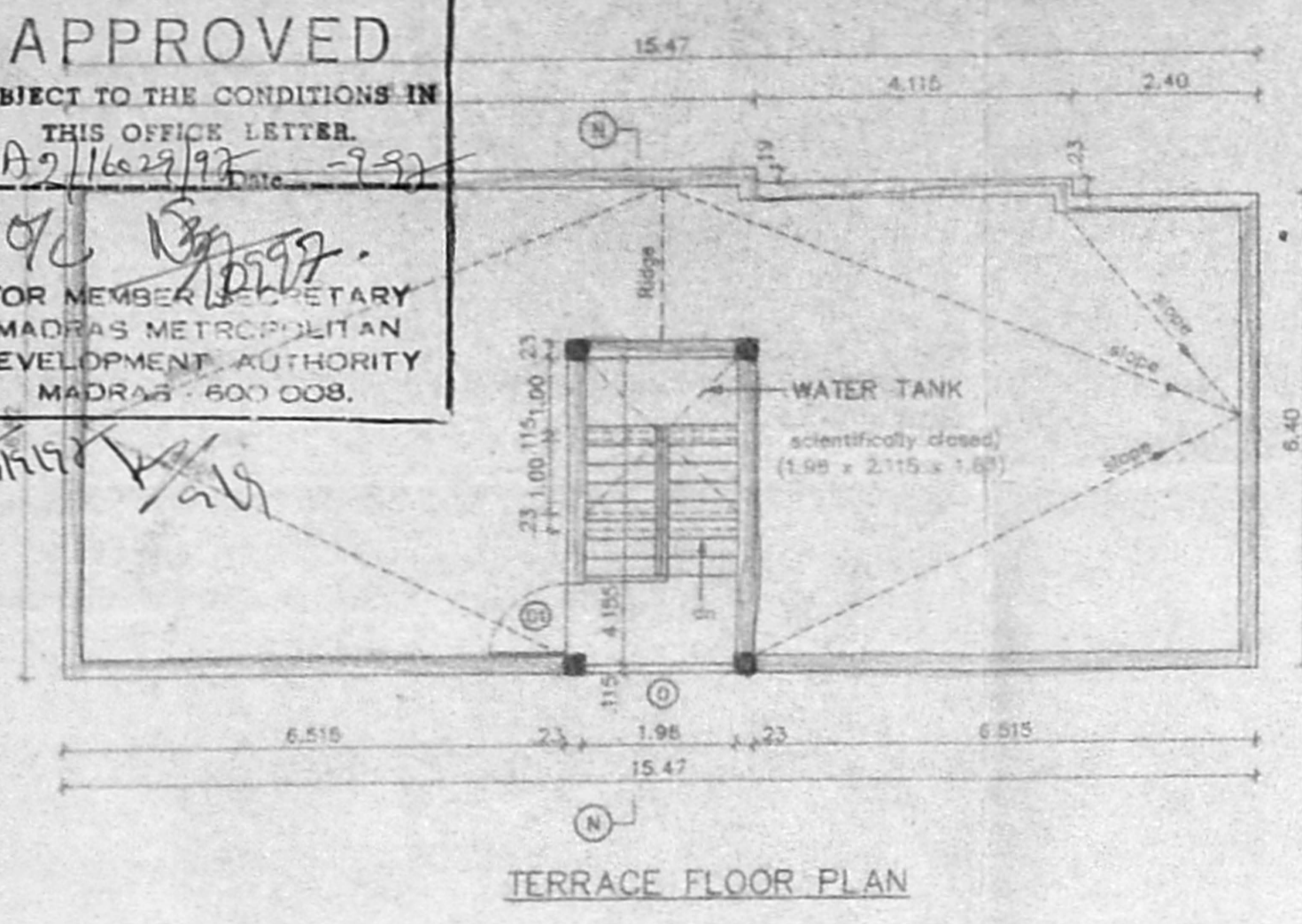

LEGEND		
CODE	SIZE	DESCRIPTION
D1	1.00 x 2.18	TEAK WOOD FRAMED FLUSH DOOR
D2	0.91 x 2.18	COUNTRY WOOD FRAMED FLUSH DOOR
D3	0.76 x 2.18	COUNTRY WOOD FRAMED FLUSH DOOR
W5	1.475 x 1.37	STEEL GLAZED WINDOW
W9	0.975 x 1.37	STEEL GLAZED WINDOW
W10	0.975 x 0.875	STEEL GLAZED WINDOW
W15	0.575 x 0.875	STEEL GLAZED WINDOW
V2	0.80 x 0.94	STEEL GLAZED VENTILATOR
O	1.98 x 1.117	OPENING

SPECIFICATION	
SL.NO	DESCRIPTION
1.	P.C.C. 1:4:8 IN FOUNDATION
2.	SAND FILLING IN FOUNDATION
3.	BRICK WORK IN C.M. 1:4
4.	R.C.C. WORK FOR SLABS, JUNCTS & BEAMS ETC.
5.	PLASTERING IN C.M. 1:3 EXTERNAL & 1:4 INTERNAL
6.	MOSAIC TILED FLOORING
7.	WEATHERING COURSE OF BRICK JELLY LIME CONC.
8.	CONCRETE BLOCK INFILL

AREA STATEMENT

PLOT AREA	210.5558 M ²
BUILT UP AREA	207.4311 M ²

COLOUR INDEX

PROPOSED CONSTRUCTION	
BOUNDARY OF SITE	
ROAD	

R.No	DATE	REVISIONS	INITIAL

1/141/133/M	23-11-98	1:100	SPIC P20CORP	R.No: 100	Checked
DRG No.	DATE	SCALE	FILE	DRAWN	CHECKED

PROPOSED CONSTRUCTION OF DWELLING UNITS IN PLOT No. 20, L.A. No. 3/95 DT. 05-06-95, AT SURVEY Nos. 249/3, 250/2, 250/3, 251/5, 254/4 & 328/1, (VILLAGE : VELACHERY) VELACHERY, TAMBARAM ROAD, MADRAS - 600 042. TALUK : MAMBALAM - GUINDY, DIV No.: 153, ZONE : X

OWNER'S SIGNATURE

P.K. SUBRAMANIAN
 B.E., M.E. (Struct.)
 Chartered Civil Engineer
 Licensed Surveyor Class-1
 L.S. No. 306 / 98 - 97

LICENSED SURVEYOR

